

Mon service déchets change

CHANGING FROM 2025



Service Public de Prévention et
de Gestion des Déchets



WHY ARE WE CHANGING ?

The new waste management service was implemented from 2022 on 84 municipalities

Anché, Brux, Chaunay, Romagne, Valence-en-Poitou et Voulon, the year 2024 corresponds to the implementation of the last 6 municipalities to have joined the trade union perimeter in 2022, the objective in this sector is to make changes from January 2025.

Faced with environmental issues, the constant increase in the TGAP (General Tax on Polluting Activities) and the various laws, the goal is clear : **to reduce waste generation reach 23% and reach 65% recycling by 2025.**

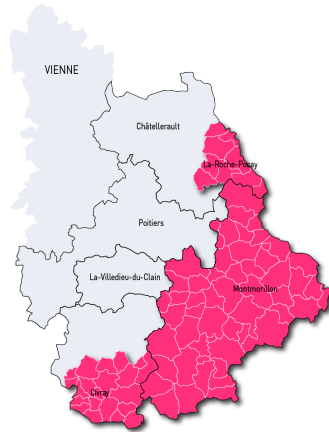

- 40 %

of Household Waste Residual

→ 120 kg in 2028 in black bins



- 23 %

waste/hab
all flows combined



65 %

of recovered waste
53% in 2020

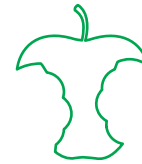

SORT

food waste at the source

WHAT'S CHANGING ?



→ the generalization of **collection in individual bins (90% of users) or less frequently in PAC* (10% of users)**

*(Point d'Apport Collectif/ Collective input point)



→ **adaptation of the frequency and the calendar of collection** corresponding the reduce of waste's production.



→ implementation of **a new individual billing rate : la Redevance Incitative**



→ reinforced support **for sort and reduction of waste** (composters, sorting facilitation...)

STEPS

2023

GOAL OF THE DISTRIBUTION OF BINS TO PROFESSIONALS AND COMMUNITIES

2024

DISTRIBUTION OF BINS TO INDIVIDUALS

2025

SETTING UP A NEW COLLECTING SCHEME AND SENDING AN ESTIMATED INVOICE

2026

END OF THE OLD BILLING METHOD AND SENDING THE FIRST REAL INCENTIVE FEE

TOMORROW'S EQUIPMENTS

WARNING : DO NOT USE BEFORE THE 1ST OF JANUARY 2022 !

The collection in **individual chipped bins** : one black for non-recoverable waste (dumped in **bags**) and one yellow for recycling waste (except glass) and papers (dumped in **bulk**). Bins are equipped with chips to record the number of times the black bin has been put into collection. So the goal is to **reduce it waste's production** and **take out the black bin only if it's full !**



INDIVIDUALS CHIPPED BINS
(90% OF USERS)



Number of people in the house	Volume of Residual Household Waste Bin	Volume of recyclable paper and packaging
1 to 2 persons	120 L	180 L
3 to 4 persons	180 L	240 L
More than 5 persons	240 L	360 L

or in **Collective input point**, accessible with the waste pass : a column for non-recoverable waste (dumped in **bags**) and a column for recycling waste (except glass) and papers (dumped in **bulk**).

In an exceptional way, other equipment can be proposed for technicals reasons (red bag, bins with key).



COLLECTIVE INPUT POINT
(PAC) (10% OF USERS)

LA REDEVANCE INCITATIVE, AN INDIVIDUAL INVOICE

How is it working ?

Nowadays, production of waste is not taken into account in the calculation of the fee. Tomorrow, a home producing less waste and sorting correctly will pay less than a home whose is not sorting. Tomorrow, the Redevance Incitative will be calculated as water or electricity, with a fixed portion and a variable portion.

FIXED PORTION

- It include the subscription at Public service for waste prevention and management : collection and treatment of household waste and recycling wastes ; collection in recycling center ; sorting center, composting platform).
- A proportionate share with a defined number of raised or deposits



VARIABLE PORTION

It is calculated based on the number of timethe black bin is collected or the number of black bag deposits in a collective input point.

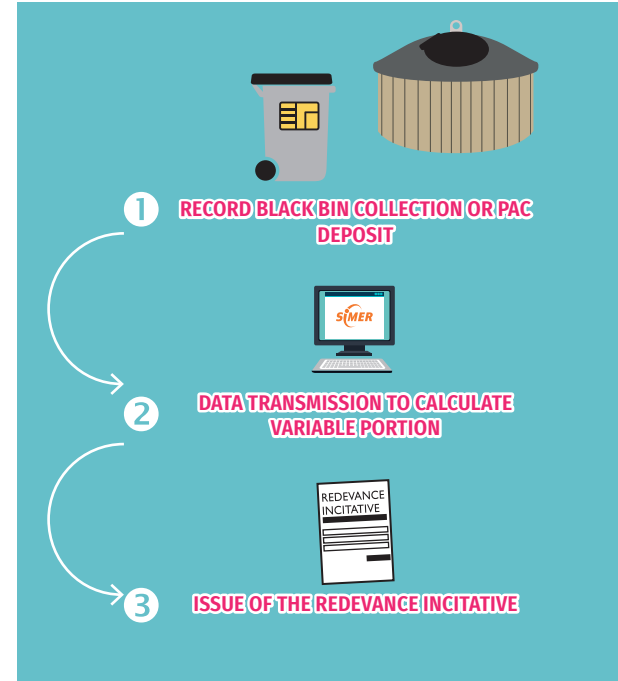

HOW TO SORT AND REDUCE ?

EVERY PACKAGING AND PAPERS : INTO YELLOW BIN

empty and not nested



PLASTIC BOTTLES



EVERY OTHER
PLASTIC PACKAGING



METAL PACKAGING



CARDBOARD
PACKAGING



NOTEBOOK AND
PAPER



NEWSPAPER AND
REVUE



BOOK, LETTERS AND
ENVELOPE

EVERY GLASS PACKAGING : INTO BOTTLE BIN

without cap and lid



JARS



BOTTLES



POTS

EVERY ORGANIC WASTE : INTO COMPOSTER

tissu and paper towel include



GARDEN WASTE



FOOD WASTE



PEELING



PLANTS



COFFEE FILTERS AND
TEA BAGS



CITRUS

HOW DOES SIMER HELP YOU ?



PREVENTIVE ACTIONS

SIMER helps you sorting and reduce your waste. A special guide Redevance Incitative will be available at the end of 2021.



COMPOSTING HELP

SIMER organise composters individuals' sales at a reduced price. You can also contact us if you want to implement a collectif composter in establishment.



PURCHASING AID

SIMER now propose a new purchasing aid for washable swaps.



Find others guides and all informations on www.simer86.fr



Do you have any questions ?

Contact us :

SIMER - Antenne de Civray

 1 Rue du chemin vert - 86 400 CIVRAY
 05 49 97 59 50
 redevanceincitative@simer86.fr

Service Public de Prévention et de Gestion des Déchets

 Eco-Pôle- La Poudrerie - 86 320 SILLARS
 05 49 91 96 42
 ecopole@simer86.fr
 www.simer86.fr
 Facebook/SIMER